



Heather Rice Quartet

Backline Rider

VOCALS AND KEYS:

Grand piano: prefer Yamaha (music stand)

Digital Keyboard: prefer Nord Stage 3 (music or Ipad stand)

Direct box for keyboard

¼ in. Cable and XLR

Lead Vocal Mic: prefer Neuman U87, alt. Beta 58/87 or better

Boom Mic Stand

GUITAR:

2 Guitars: Yamaha AES 1500, or an archtop with humbucking pickups, a strat/Paul Reed Smith or something comparable

an analog delay and an overdrive, preferable a Timmy or The Dude by J Rockett Audio Design.

Guitar stand

A Fender combo tube amp, preferably under 50 watts

BASS:

For upright: Pref. Shen bass

For electric:, Prefer Fender Jazz or Precision

Prefer Markbass Amps.

DRUMS:

Drum set, Pref. Canopus, Gretsch, Craviotto, Yamaha. Sizes:

14x5.5 snare drum, 12x8 mounted tom, 14x14 floor tom, 18x14 bass drum- if an 18" bass drum is unavailable, 20" is fine.

Coated Remo Ambassadors for all batter side heads

Clear Remo Diplomats for all resonant side heads
 Coated Remo Ambassador for resonant side bass drum head.
 One hi-hat stand
 two flat base straight cymbal stands
 One non-slip rug at least 6'x4' in size.

SOUND:

Direct boxes for guitar, bass, and keys, unless using an acoustic piano
 4 Monitor Wedges: prefer QSC K8-10
 Professional FOH Sound System and Professional engineer
 3 20-amp circuits center stage
 Artists to send Left and Right to A/V mixing console.
 Drums: 2 overhead mics, one bass drum mic and one snare drum mic.

LIGHTING:

Light trees with appropriate washes to cover stage

STAGE AREA:

Min. 16x12

Heather Rice (Quartet)

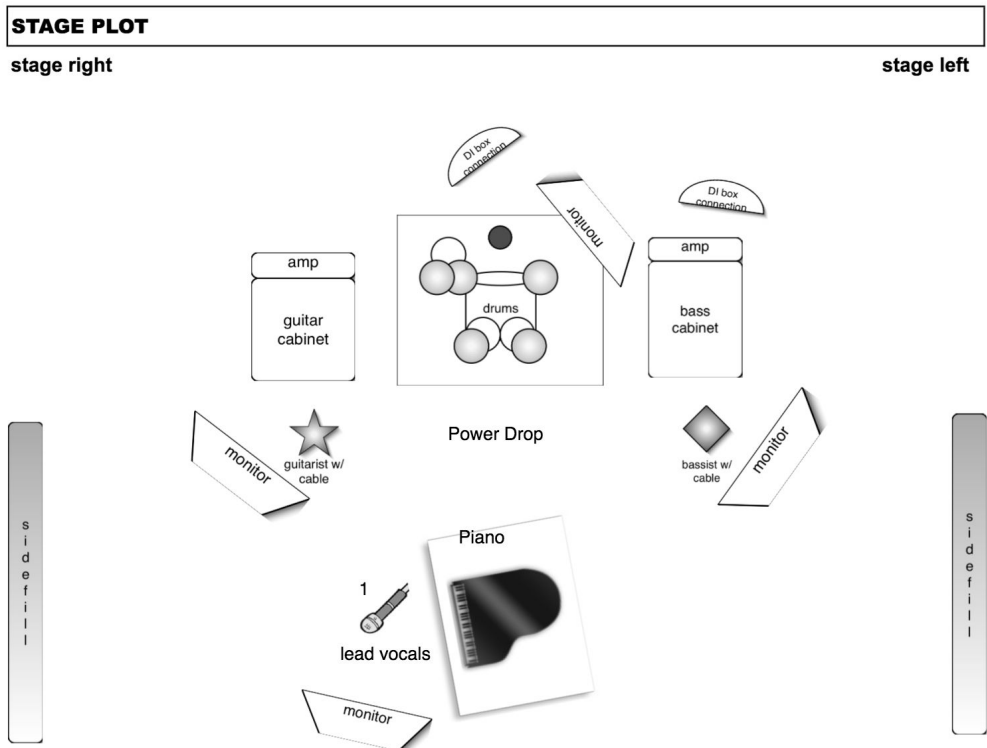

INPUT LIST

Channel	Inst.	Mics	Stands	Notes	Monitor Mix
1.	Vocals	Neumann U87	boom stand	XLR Cable	All/ Center
2.	Piano	DI	(if digital keys)	high stool or drum throne	
3.	Guitar	Sennheiser E906	small boom	tube amp	All
4.	Bass	DI	XLR cable	Markbass amp	Drums/ keys
5.	Drums	2 overheads 1 bass drum 1 snare			Left/Center/Right